

THE POLO CLUB PLAT II
PART OF THE POLO CLUB P.U.D.
SITUATE IN SECTIONS 26, 27, 34 AND 35, TOWNSHIP 46 SOUTH, RANGE 42 EAST
PALM BEACH COUNTY, FLORIDA
APRIL, 1987 SHEET 2 OF 4

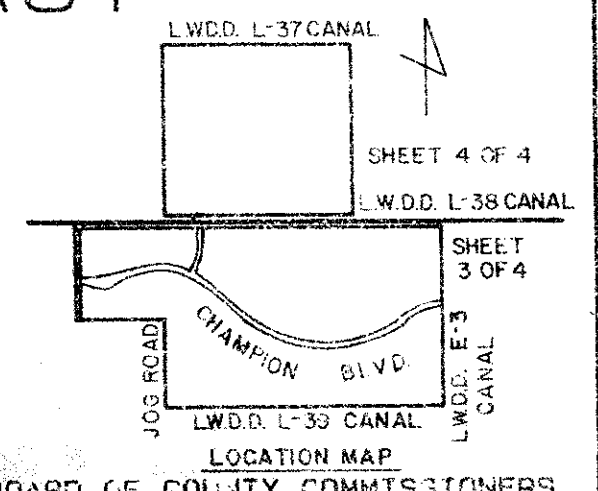

STATE OF FLORIDA
COUNTY OF PALM BEACH
THIS PLAT WAS FILED FOR RECORD
THIS DAY OF
AD, 1987 AND DULY RECORDED
IN PLAT BOOK ON PAGES
AND
JOHN B. DUNKLE, CLERK
BY: , D.C.

DRAWING NUMBER
57/47

DRAWING NUMBER

DRAWING NUMBER

DRAWING NUMBER

BTGAREE'S CONSENT

STATE OF FLORIDA
COUNTY OF PALM BEACH
CARTERET SAVINGS BANK, F.A., HEREBY CERTIFIES THAT IT IS A HOLDER OF A MORTGAGE UPON THE PROPERTY HEREON DESCRIBED AND DOES HEREBY JOIN IN AND CONSENT TO THE DEDICATION OF SAID LANDS BY THE OWNERS THEREOF...

IN WITNESS WHEREOF, CARTERET SAVINGS BANK, F.A., HAS CAUSED THESE PRESENTS TO BE SIGNED BY ITS VICE PRES. AND ATTESTED TO BY ITS ASSIST. SECY.

ST: GAIL SIMMONS, ASSISTANT SECRETARY
BY: ARTHUR G. MARTELL, VICE PRESIDENT

STATE OF FLORIDA
COUNTY OF PALM BEACH
BEFORE ME PERSONALLY APPEARED ARTHUR G. MARTELL AND GAIL SIMMONS, TO ME WELL KNOWN AND KNOWN TO ME TO BE THE INDIVIDUALS DESCRIBED IN AND WHO EXECUTED THE FOREGOING INSTRUMENT AS VICE PRES. AND ASSIST. SECY. OF CARTERET SAVINGS BANK, F.A., AND SEVERALLY ACKNOWLEDGED TO AND BEFORE ME THAT THEY HAD SAID INSTRUMENT AS SUCH OFFICERS OF SAID CORPORATION...

WITNESS MY HAND AND OFFICIAL SEAL THIS DAY OF May, 1987.
MY COMMISSION EXPIRES: 2/9/89

MORTGAGEE'S CONSENT
STATE OF CALIFORNIA
COUNTY OF LOS ANGELES

SECURITY PACIFIC NATIONAL BANK, A NATIONAL BANKING ASSOCIATION, HEREBY CERTIFIES THAT IT IS A HOLDER OF A MORTGAGE UPON THE PROPERTY HEREON DESCRIBED AND DOES HEREBY JOIN IN AND CONSENT TO THE DEDICATION OF SAID LANDS BY THE OWNERS THEREOF...

IN WITNESS WHEREOF, SECURITY PACIFIC NATIONAL BANK, A NATIONAL BANKING ASSOCIATION, HAS CAUSED THESE PRESENTS TO BE SIGNED BY ITS SENIOR VICE PRESIDENT AND ATTESTED TO BY ITS ASSISTANT SECRETARY...

ATTEST: KIM ABRAHAM, ASSISTANT SECRETARY
BY: ALVIN WILKINSKI, SENIOR VICE PRESIDENT

ACKNOWLEDGEMENT
STATE OF CALIFORNIA
COUNTY OF LOS ANGELES

BEFORE ME PERSONALLY APPEARED Kim Abraham and Everton B. Coors, TO ME WELL KNOWN AND KNOWN TO ME TO BE THE INDIVIDUALS DESCRIBED IN AND WHO EXECUTED THE FOREGOING INSTRUMENT AS ASSIST. SECY. AND SENIOR VICE PRESIDENT OF SECURITY PACIFIC NATIONAL BANK AND ACKNOWLEDGED TO AND BEFORE ME THAT THEY EXECUTED SAID INSTRUMENT AS SUCH OFFICERS OF SAID CORPORATION...

WITNESS MY HAND AND OFFICIAL SEAL THIS DAY OF May, 1987.
MY COMMISSION EXPIRES: 7/17/90

MORTGAGEE'S CONSENT
STATE OF FLORIDA
COUNTY OF PALM BEACH

RAINBERRY DEVELOPMENT FOUR, INC. AND FIRST AMERICAN EQUITY POLO CORPORATION, A JOINT VENTURE DOING BUSINESS AS THE POLO CLUB, HEREBY CERTIFIES THAT IT IS A HOLDER OF A MORTGAGE UPON THE PROPERTY HEREON DESCRIBED AND DOES HEREBY JOIN IN AND CONSENT TO THE DEDICATION OF SAID LANDS BY THE OWNERS THEREOF...

IN WITNESS WHEREOF, RAINBERRY DEVELOPMENT FOUR, INC. AND FIRST AMERICAN EQUITY POLO CORPORATION, A JOINT VENTURE DOING BUSINESS AS THE POLO CLUB, HAS CAUSED THESE PRESENTS TO BE SIGNED BY ITS PRESIDENT AND ATTESTED TO BY ITS VICE PRESIDENT...

ATTEST: MARIAN PEARLMAN NEASE, SECRETARY
BY: ROY FLACK, PRESIDENT

IN WITNESS WHEREOF, EQUITABLE MORTGAGE RESOURCES, INC., HAS CAUSED THESE PRESENTS TO BE SIGNED BY ITS VICE PRESIDENT AND ATTESTED TO BY ITS ASSIST. SECRETARY AND ITS CORPORATE SEAL TO BE AFFIXED HERETO BY AND WITH THE AUTHORITY OF ITS BOARD OF DIRECTORS THIS DAY OF May, 1987.

ATTEST: SALLIE LOU BROWN, ASSISTANT SECRETARY
BY: LAWRENCE A. WIELINSKI, JR., VICE PRESIDENT

ACKNOWLEDGEMENT
STATE OF FLORIDA
COUNTY OF PALM BEACH

BEFORE ME PERSONALLY APPEARED Sallie Lou Brown and Lawrence A. Wielinski, Jr. TO ME WELL KNOWN AND KNOWN TO ME TO BE THE INDIVIDUALS DESCRIBED IN AND WHO EXECUTED THE FOREGOING INSTRUMENT AS ASSIST. SECY. AND VICE PRESIDENT OF EQUITABLE MORTGAGE RESOURCES, INC., AND SEVERALLY ACKNOWLEDGED TO AND BEFORE ME THAT THEY EXECUTED SAID INSTRUMENT AS SUCH OFFICERS OF SAID CORPORATION...

WITNESS MY HAND AND OFFICIAL SEAL THIS DAY OF May, 1987.
MY COMMISSION EXPIRES: 5/21/89

MORTGAGEE'S CONSENT
STATE OF CALIFORNIA
COUNTY OF LOS ANGELES

SECURITY PACIFIC NATIONAL BANK, A NATIONAL BANKING ASSOCIATION, HEREBY CERTIFIES THAT IT IS A HOLDER OF A MORTGAGE UPON THE PROPERTY HEREON DESCRIBED AND DOES HEREBY JOIN IN AND CONSENT TO THE DEDICATION OF SAID LANDS BY THE OWNERS THEREOF...

IN WITNESS WHEREOF, SECURITY PACIFIC NATIONAL BANK, A NATIONAL BANKING ASSOCIATION, HAS CAUSED THESE PRESENTS TO BE SIGNED BY ITS SENIOR VICE PRESIDENT AND ATTESTED TO BY ITS ASSISTANT SECRETARY...

ATTEST: KIM ABRAHAM, ASSISTANT SECRETARY
BY: ALVIN WILKINSKI, SENIOR VICE PRESIDENT

ACKNOWLEDGEMENT
STATE OF CALIFORNIA
COUNTY OF LOS ANGELES

BEFORE ME PERSONALLY APPEARED Kim Abraham and Everton B. Coors, TO ME WELL KNOWN AND KNOWN TO ME TO BE THE INDIVIDUALS DESCRIBED IN AND WHO EXECUTED THE FOREGOING INSTRUMENT AS ASSIST. SECY. AND SENIOR VICE PRESIDENT OF SECURITY PACIFIC NATIONAL BANK AND ACKNOWLEDGED TO AND BEFORE ME THAT THEY EXECUTED SAID INSTRUMENT AS SUCH OFFICERS OF SAID CORPORATION...

WITNESS MY HAND AND OFFICIAL SEAL THIS DAY OF May, 1987.
MY COMMISSION EXPIRES: 8/29/89

MORTGAGEE'S CONSENT
STATE OF FLORIDA
COUNTY OF PALM BEACH

RAINBERRY DEVELOPMENT FOUR, INC. AND FIRST AMERICAN EQUITY POLO CORPORATION, A JOINT VENTURE DOING BUSINESS AS THE POLO CLUB, HEREBY CERTIFIES THAT IT IS A HOLDER OF A MORTGAGE UPON THE PROPERTY HEREON DESCRIBED AND DOES HEREBY JOIN IN AND CONSENT TO THE DEDICATION OF SAID LANDS BY THE OWNERS THEREOF...

IN WITNESS WHEREOF, RAINBERRY DEVELOPMENT FOUR, INC. AND FIRST AMERICAN EQUITY POLO CORPORATION, A JOINT VENTURE DOING BUSINESS AS THE POLO CLUB, HAS CAUSED THESE PRESENTS TO BE SIGNED BY ITS PRESIDENT AND ATTESTED TO BY ITS VICE PRESIDENT...

ATTEST: MARIAN PEARLMAN NEASE, SECRETARY
BY: ROY FLACK, PRESIDENT

IN WITNESS WHEREOF, RAINBERRY DEVELOPMENT FOUR, INC. AND FIRST AMERICAN EQUITY POLO CORPORATION, A JOINT VENTURE DOING BUSINESS AS THE POLO CLUB, HAS CAUSED THESE PRESENTS TO BE SIGNED BY ITS PRESIDENT AND ATTESTED TO BY ITS VICE PRESIDENT...

ATTEST: MARIAN PEARLMAN NEASE, SECRETARY
BY: ROY FLACK, PRESIDENT

ACKNOWLEDGEMENT
STATE OF FLORIDA
COUNTY OF PALM BEACH

BEFORE ME PERSONALLY APPEARED ROY FLACK AND MARIAN PEARLMAN NEASE, TO ME WELL KNOWN AND KNOWN TO ME TO BE THE INDIVIDUALS DESCRIBED IN AND WHO EXECUTED THE FOREGOING INSTRUMENT AS PRESIDENT AND SECRETARY OF RAINBERRY DEVELOPMENT FOUR, INC., A FLORIDA CORPORATION...

WITNESS MY HAND AND OFFICIAL SEAL THIS DAY OF May, 1987.
MY COMMISSION EXPIRES: 5/21/89

ACKNOWLEDGEMENT
STATE OF FLORIDA
COUNTY OF PALM BEACH

BEFORE ME PERSONALLY APPEARED ROY FLACK AND MARIAN PEARLMAN NEASE, TO ME WELL KNOWN AND KNOWN TO ME TO BE THE INDIVIDUALS DESCRIBED IN AND WHO EXECUTED THE FOREGOING INSTRUMENT AS PRESIDENT AND SECRETARY OF RAINBERRY DEVELOPMENT FOUR, INC., A FLORIDA CORPORATION...

WITNESS MY HAND AND OFFICIAL SEAL THIS DAY OF May, 1987.
MY COMMISSION EXPIRES: 5/21/89

ACKNOWLEDGEMENT
STATE OF FLORIDA
COUNTY OF PALM BEACH

BEFORE ME PERSONALLY APPEARED RICHARD C. PREISER AND GORDON B. COORS TO ME WELL KNOWN AND KNOWN TO ME TO BE THE INDIVIDUALS DESCRIBED IN AND WHO EXECUTED THE FOREGOING INSTRUMENT AS PRESIDENT AND VICE PRESIDENT OF FIRST AMERICAN EQUITY POLO CORPORATION, A FLORIDA CORPORATION...

WITNESS MY HAND AND OFFICIAL SEAL THIS DAY OF June, 1987.
MY COMMISSION EXPIRES: 5/21/89

TITLE CERTIFICATION
WE, BRAD AND CASSEL, DO HEREBY CERTIFY THAT WE HAVE EXAMINED THE TITLE TO THE HEREON DESCRIBED PROPERTY...

DATE: 5/21/87
BY: JEFFREY A. DEUTCH

CURVEYOR'S CERTIFICATE
I HEREBY CERTIFY THAT THE PLAT SHOWN HEREON IS A TRUE AND CORRECT REPRESENTATION OF A SURVEY MADE UNDER MY RESPONSIBLE DIRECTION...

THIS DAY OF May, 1987
MICHAEL A. MANZIE
PROFESSIONAL LAND SURVEYOR
FLORIDA CERTIFICATE NO. 4669

APPROVALS

PALM BEACH COUNTY BOARD OF COUNTY COMMISSIONERS
PALM BEACH COUNTY, FLORIDA

THIS PLAT IS HEREBY APPROVED FOR RECORD THIS 14th DAY OF July, 1987.

ATTEST: JOHN B. DUNKLE, CLERK
BY: Kathryn S. Miller, DEPUTY CLERK

COUNTY ENGINEER
THIS PLAT IS HEREBY APPROVED FOR RECORD THIS 14th DAY OF JULY, 1987.

ATTEST: HERBERT F. KAHLERT, P.E., COUNTY ENGINEER

SURVEYOR'S NOTES

- 1. ALL BEARINGS SHOWN HEREON REFER TO AN ASSUMED BEARING OF N89°07'44"E ALONG THE NORTH LINE OF THE NORTHWEST ONE-QUARTER OF SECTION 35, TOWNSHIP 46 SOUTH, RANGE 42 EAST, PALM BEACH COUNTY, FLORIDA...

- 2. THERE SHALL BE NO BUILDINGS OR ANY KIND OF CONSTRUCTION PLACED ON UTILITY OR DRAINAGE EASEMENTS.

- 3. THERE SHALL BE NO TREES OR SHRUBS PLACED ON UTILITY EASEMENTS WHICH ARE PROVIDED FOR WATER AND SEWER USE OR UPON DRAINAGE EASEMENTS.

- 4. LANDSCAPING OR OTHER UTILITY EASEMENTS SHALL BE ALLOWED ONLY AFTER CONSENT OF ALL UTILITY COMPANIES OCCUPYING SAME.

- IN THOSE CASES WHERE EASEMENTS OF DIFFERENT TYPES CROSS, DRAINAGE EASEMENTS SHALL HAVE FIRST PRIORITY, UTILITY EASEMENTS SHALL HAVE SECOND PRIORITY, ACCESS EASEMENTS SHALL HAVE THIRD PRIORITY, AND ALL OTHER EASEMENTS SHALL BE SUBORDINATE TO THESE WITH THEIR PRIORITIES BEING DETERMINED BY THE USE RIGHTS GRANTED.

- 5. ALL LINES WHICH INTERSECT CURVES ARE RADIAL TO THESE CURVES UNLESS OTHERWISE NOTED.

- 6. THE BUILDING SETBACK LINE SHALL BE AS REQUIRED BY CURRENT PALM BEACH COUNTY ZONING REGULATIONS.

Table with 2 columns: PROPERTY DIMENSIONAL DATA and values. Includes rows for TOTAL AREA, DENSITY, TOTAL DWELLING UNITS, BUILDING COVERAGE, USE AREA, OPEN SPACE, and FLOOR AREA.

THIS INSTRUMENT WAS PREPARED BY MARY HANNA OLGUZZI IN THE OFFICES OF STANLEY/MERIDIAN SURVEYING AND MAPPING, INC., 2000 LOMBARD STREET, WEST PALM BEACH, FLORIDA 33407.

0436-022

57/47

Meridian Surveying and Mapping Inc. logo and contact information. Includes address: 2000 LOMBARD STREET, WEST PALM BEACH, FL. Includes a drawing log table with columns for DRAWN, CHECKED, DATE, and SCALE.

SEAL CARTERET SAVINGS BANK N.A.
SEAL NOTARY PUBLIC
SEAL CENVILL INVESTORS, INC.
SEAL NOTARY PUBLIC

SEAL EQUITABLE MORTGAGE RESOURCES, INC.
SEAL NOTARY PUBLIC
SEAL SECURITY PACIFIC NATIONAL BANK
SEAL NOTARY PUBLIC

SEAL RAINBERRY DEVELOPMENT FOUR, INC.
SEAL NOTARY PUBLIC
SEAL FIRST AMERICAN EQUITY POLO CORPORATION
SEAL NOTARY PUBLIC

SEAL PROFESSIONAL LAND SURVEYOR
SEAL COUNTY ENGINEER